

**FIXING TYPE B**  
4.7 kN

**CHOOSE ANY OF THE 3 OPTIONS BELOW  
STUD TO TOP PLATE**

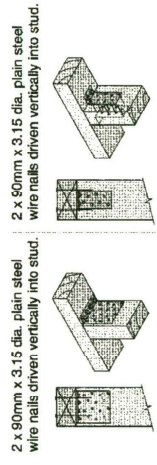

2 x 90mm x 3.15 dia. plain steel wire nails driven vertically into stud.  
2 x 90mm x 3.15 dia. plain steel wire nails driven vertically into stud.  
Plus LUMBERLOK 6kN Stud Anchor (CP-65a)  
2 x LUMBERLOK CPC40  
Recommended for internal wall options to avoid lining issues

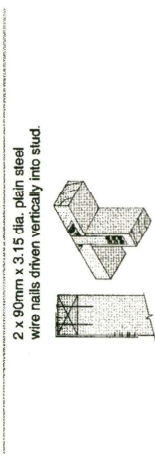

Plus LUMBERLOK Stud Strap (one face only)  
2 x 90mm x 3.15 dia. plain steel wire nails driven vertically into stud.

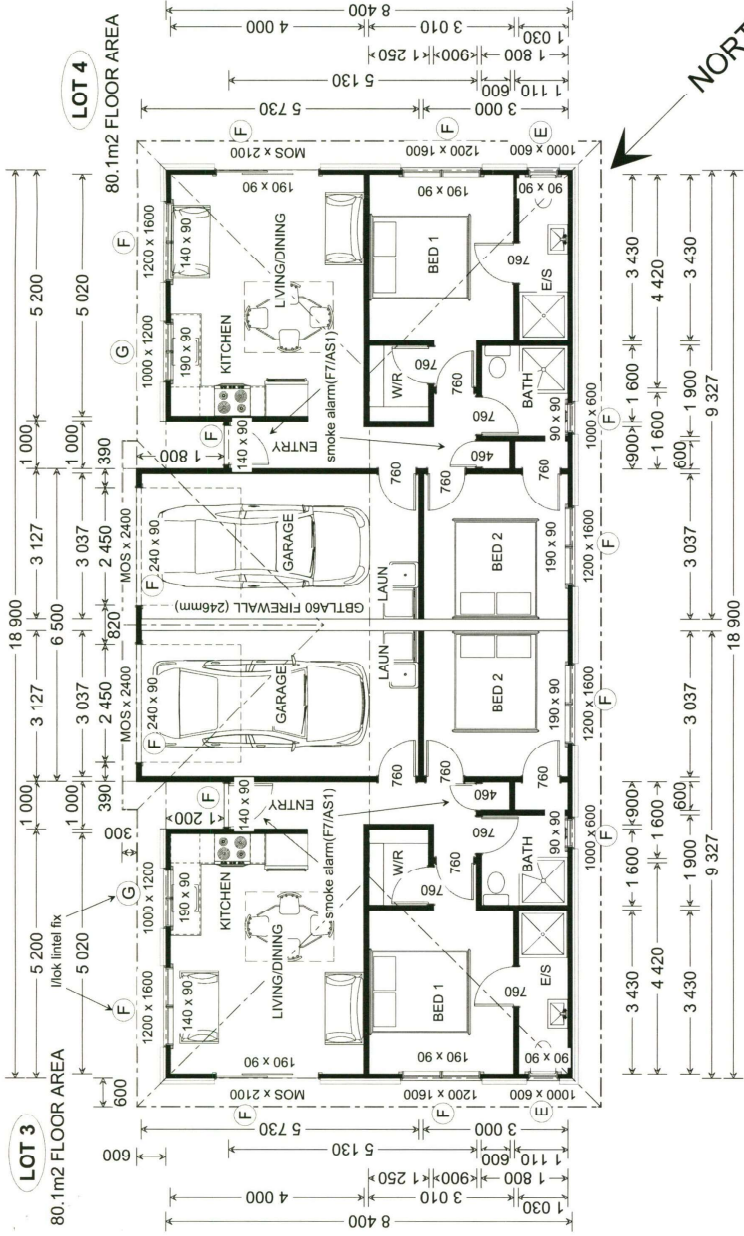

**FLOOR PLAN**  
1:100 SCALE  
2455 TO UNDERSIDE OF TRUSSES  
WINDOWS & EXT. DOORS UP TO SOFFIT  
WET AREA FLOOR FINISH TO TILES  
WET AREA FLOOR FINISH TO TILES  
SHOWERS TO BE INBUILT PVC CUBICLES OVER GIB AQUALINE  
MINIMUM) IE: DOUBLE GLAZING

**REFER ENGINEER DESIGN FOR FLOOR & FOOTINGS**  
ALL FRAMING ASSUMED TO BE 90 mm (90 x 45 H.1.2 STUDS @ 600 CRS/2 ROWS OF NOGS)  
WALL & ROOF FRAMING TO BE SG8 GRADE/H.1.2 TREATMENT UNLESS OTHERWISE STATED  
ALL WINDOWS & DOORS TO COMPLY WITH NZS 4211/4223

**BUILDING ENVELOPE RISK MATRIX**

RISK FACTOR	LOW	MEDIUM	HIGH	VERY HIGH	SUITE TOTALS
WIND ZONE (NSZ 3604)	0	0	1	2	0
NUMBER OF STOREYS	0	1	2	4	1
ROOFWALL INTERSECTION DESIGN	0	1	3	5	0
EAVES WIDTH	0	1	2	5	0
ENVELOPE COMPLEXITY	0	1	3	6	1
DECK DESIGN	0	2	4	6	0
<b>TOTAL RISK SCORE</b>	<b>0</b>	<b>4</b>	<b>14</b>	<b>24</b>	<b>2</b>

**EXPOSURE ZONE B**



ALL WORK TO BE CARRIED OUT IN ACCORDANCE WITH NZS3604 (2011) AND LOCAL COUNCIL BYLAWS.. BUILDER AND ALL CONTRACTORS TO CHECK AND VERIFY ALL DETAILS AND DIMENSIONS ETC. PRIOR TO COMMENCEMENT OF ANY WORK

**ELEVATIONS**  
Tom Hansen  
Plan Service  
Phone 07 5480698



**Type E - 1.4 kN**

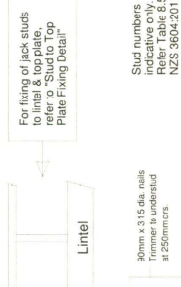

For fixing of jack studs to lintel & top plate, refer to "Stud to Top Plate Fixing Detail"  
Stud numbers indicative only. Refer Table 6.5 NZS 3604:2011

**Type F - 4.0 kN**

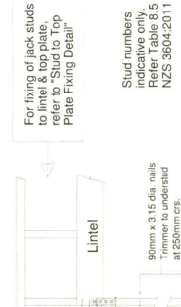

For fixing of jack studs to lintel & top plate, refer to "Stud to Top Plate Fixing Detail"  
Stud numbers indicative only. Refer Table 6.5 NZS 3604:2011

**Type G - 7.5 kN**



For fixing of jack studs to lintel & top plate, refer to "Stud to Top Plate Fixing Detail"  
Stud numbers indicative only. Refer Table 6.5 NZS 3604:2011

**LUMBERLOK LINTEL FIXING**

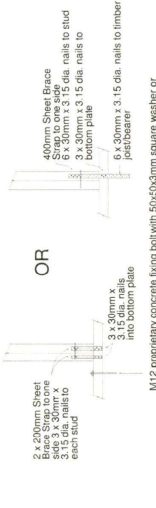

For fixing of jack studs to lintel & top plate, refer to "Stud to Top Plate Fixing Detail"  
Stud numbers indicative only. Refer Table 6.5 NZS 3604:2011

2 x 200mm Sheet Braces, 2x 90mm x 3.15 dia. nails to even stud  
2 x 90mm x 3.15 dia. nails to bottom plate  
M12 x 150mm coach screw with 50x50x30mm square washer into timber post bearer.

LICENSED BUILDING PRACTITIONER design 1 (LBP 1109999)  
ARCHITECTURAL DESIGNER

NOVEMBER 2017